



## 250 Series

### Two and Four Button Radio Remotes



The '250 Series' Two and Four Button Radio Remotes are a compact design for use with Automatic Gates, Garage Doors, Car Turntables and other products requiring a remote radio control

Performance Required	250K-SLIM	250T-4	250K-SLIMRP	250T-4RP
Range	Approximately up to 200 metres in the open (the effective range depends on terrain, Antenna quality and possible radio interference)			
Frequency	433.92MHz (± 100kHz)			
Radio Coding	Dip-switch 1,024 codes		Rolling Code	
Battery	2 x CR2016			
Estimated Battery Life	Approx. 2 years, with 10 operations per day			
Protection Degree	IP44			
Operating Temp	-20 <sup>0</sup> – +55 <sup>0</sup> c			
LED Colour	Red		Green	
Ordering Code	250K-SLIM	250T-4	250K-SLIMRP	250T-4RP

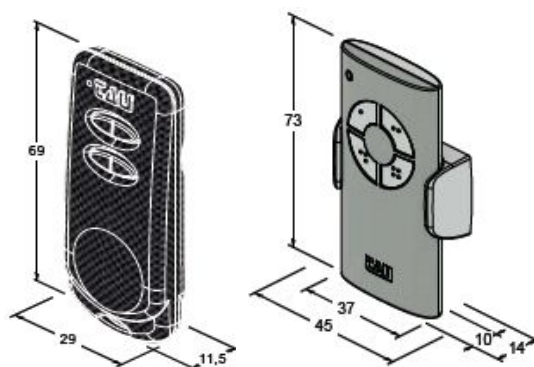

250K-SLIM  
250K-SLIMRP

250T-4  
250T-4RP

Dimensions

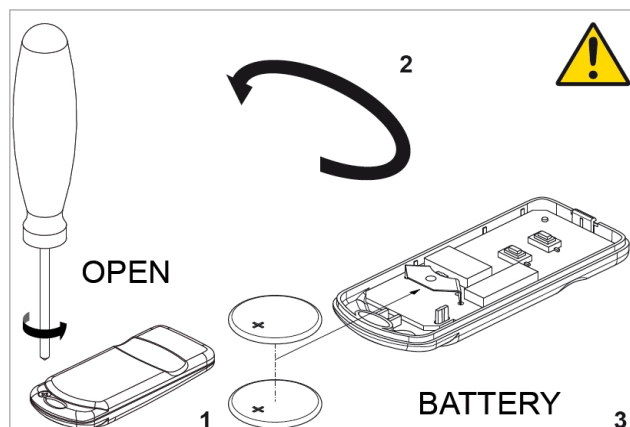

250K-SLIM & 250K-SLIMRP

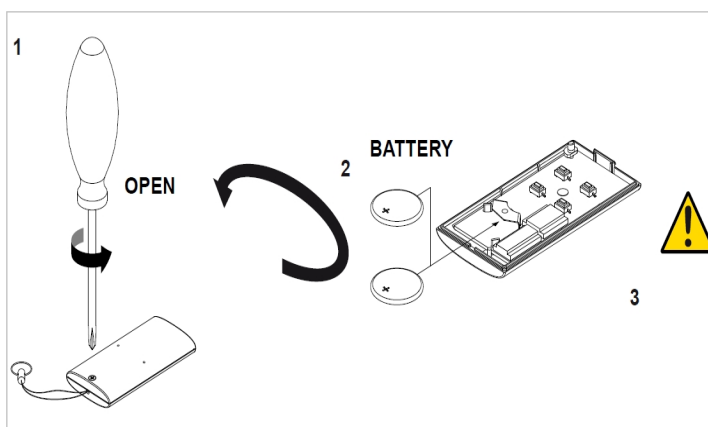

250T-4 & 250T-4RP



**ATTENTION:** Ensure the Batteries are replaced with the correct ones, (2 x CR2016) as failure to do so may cause an explosion.



DIP SW 1-10 Programmable Code  
DIP SW 11 Not Available  
DIP SW 12 (ON) Higher Range  
DIP SW 12 (OFF) Longer Battery Life

Imported and marketed in New Zealand by GATE DRIVE SOLUTIONS LTD

[www.gatedrivesolutions.co.nz](http://www.gatedrivesolutions.co.nz) Phone: 09 419 5483

The information contained in this document is subject to change without notice. May 2017





## 250 Series

### One, Two and Four Channel 433.92 MHz Radio Receivers



The '250 Series' One, Two and Four Channel Radio Receivers are a compact design for use with Automatic Gates, Garage Doors, Vehicle Turntables and other products requiring a remote radio control

PRODUCT	FEATURES	NUMBER OF CHANNELS	MEMORY/CODES	INPUT VOLTAGE	POTENTIAL FREE CONTACT OUTPUT	MAX. OUTPUT RATING UP TO 24V DC TO 220 VAC NON-INDUCTIVE	FIXED PULSE MODE (Approx. 1-2 seconds)	SUSTAINED PULSE/DELAY MODE	BI-STABLE (Step-by-step) MODE
    	<b>250RX1DCB</b>	1	62*	12V dc 24V ac	YES	3A	YES	YES**	YES***
	<b>250RX2DCB</b>	2	62*	12V dc 24V ac	YES	3A	YES	YES**	YES***
	<b>250RXDC4</b>	4	62*	12V dc 24V ac	YES	3A	YES	YES**	YES***
	<b>250RXDC4T</b>	4	62*	230V ac	YES	3A	YES	YES**	YES***
	<b>250ANTD1</b>	Tuned Antenna with bracket for 433.92MHz Radio Receivers with a 4 metre lead							

**\*Code Limitations:** Unlimited when DIP Switch (Fixed) Code Remotes are used. The 62 Memory Slots are across the 2 or 4 Channels, if Rolling Code Radio Remotes are used.

**\*\* Timed Mode:** The Output relay contact closes for approx. 3 minutes (cannot be varied)

**\*\*\* Bi-stable or Step-by-step mode:** At each impulse given by the Radio Remote, the output relay contact changes its logic state: closed-open, open-closed.....

Imported and marketed in New Zealand by GATE DRIVE SOLUTIONS LTD

www.gatedrivesolutions.co.nz Phone: 09 419 5483

The information contained in this document is subject to change without notice. May 2017